



WARRANDYTE TOWNSHIP HERITAGE GUIDELINES PARTS 1 TO 7

Part 3 - Alterations & Additions to Non Contributory Properties in Commercial Areas



July 2007

Elements of Heritage Significance

Alterations and additions

- Semi-rural village where buildings are secondary to the landscape.
- Significant buildings are scattered throughout the precinct. They generally sit alone and are of weatherboard construction with pitched roofs that are generally clad in corrugated iron.
- Heritage elements as the visually dominant feature of significant properties and the heritage area.
- Traditional materials, colour schemes and detailing incorporated into buildings.
- Plentiful vacant spaces allowing public views to the river, treed slopes and into and across properties.
- A sense of space and the dominance of landscape in views between and across sites.
- Generous front and side set backs comprising grassed slopes and native and exotic vegetation with trees and medium height shrubs along property boundaries.
- Buildings sited and stepped down on hill slopes.
- Single lane and coarse driveways.
- Low, simple and visually permeable fencing.



Yarra Street shops



The east entrance to the Warrandyte Township Heritage Precinct



View to the north of Yarra Street showing a shop which is low in form with a pitched roof allowing views to the treed valley and down to the river. The building steps down the slope rather than cutting into the embankment.

Operation

The guidelines are to be used in the preparation and assessment of a planning permit application under Heritage Overlay. The guidelines provide a series of heritage design objectives which must be met. Each design objective includes a set of design suggestions that provide guidance as to the how to achieve the objective.

Warrandyte Township Heritage Guidelines Parts 1 to 7

Index	Page No.
Introduction	1
Elements of Heritage Significance	1
Operation	1
Guidelines	3
Significant Views	3
Retain the Natural Topography	3
Changes to Facades	3
Additions	4
Upper Storey Additions	4
Openings	5
Verandahs	5
Materials	5
Exterior Painting	5
Design Excellence	5
Detailing	6
Roads, Paths & Views	6
Fences	7
Side & Rear Fences	8
Car Parking	8
Exterior Paint Colour Chart	9
Table 1 – List of Contributory Properties	10
Warrandyte Township Heritage Precinct	11
Heritage Contacts & Reference Documents	12

Significant Views

Objective 3.1

To ensure alterations retain the public view of adjacent significant properties and do not adversely impact on the streetscape.

Design suggestions

- Alterations should be designed and located to retain existing public views.
- Alterations should maintain the same relationship with adjacent properties.
- Alterations should be sympathetic to the streetscape.
- Alterations should not adversely impact the understanding and character of a heritage area.



Yarra Street west end commercial properties

Retain the Natural Topography

Objective 3.2

To ensure new additions reflect the natural topography.

Design suggestions

- Avoid creating areas of flat land which alter the natural topography
- Minimise the nature and extent of cut and fill development.
- Step new additions to reflect the natural topography.
- Development on the upslope side of the precinct, particularly on south side of Yarra Street, should balance the form, scale and mass of additions against the amount of required earthworks to ensure that the height and proportion of the addition reflects the character of the streetscape.

Changes to Visible Facades

Objective 3.3

To ensure that changes complement the significant elements of the heritage area and do not dominate the streetscape.

Design suggestions

- Large areas of glass or blank wall should be avoided.
- The scale of openings (windows and doors) should be similar to those of contributory buildings.
- Changes to openings (windows and doors) and detailing (eg. balustrades) that can be viewed by the public should be consistent with style of the property.
- Avoid replication of heritage details.
- Detailing of the addition should be simple.
- Recessed entry into the building should be retained.

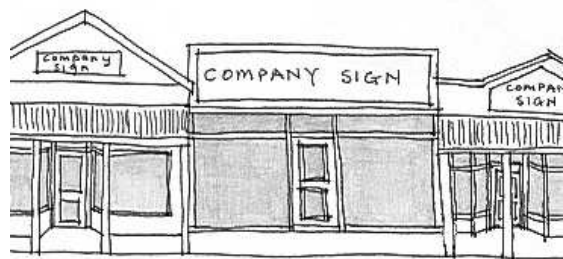

Bad example of alterations to a non contributory building

Alterations to the central building above have not retained the recessed entry similar to contributory buildings either side. The dominance of the building in the streetscape is compounded by the absence of a verandah and floor to ceiling glazing which does not reflect the existing street patterning



Yarra Street west end commercial properties

Additions

Objective 3.4

To ensure additions retain the visual dominance of the significant elements of the heritage area.

Design suggestions

- An addition should not overwhelm or dominate the streetscape.
- Major additions of a size comparable to or greater than the existing building should be designed and located as a distinct visual entity.

- Ensure minimal visibility from the street by designing upper storey additions within the building envelope determined by sight lines from the street.
- Site upper storey additions behind the ridgeline of the main roof form of the existing building.
- Use of pitched roof forms or shaped parapets

Upper Storey Additions

Objective 3.5

To ensure upper storey additions have minimal impact from the street.

Design suggestions

- An addition should not overwhelm or dominate the streetscape.
- Upper storey additions should respond to the height and number of storeys of adjacent buildings.



Retail buildings in Yarra Street

Appropriate upper storey additions which do not dominate the streetscape have previously been undertaken to commercial properties in Yarra Street as shown above.

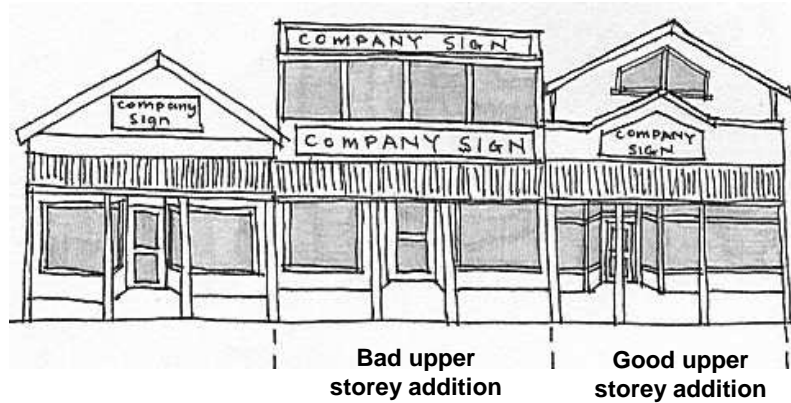

The above diagram shows a bad and good example of an upper storey addition to a commercial building. The centre example dominates the streetscape due to its bulk and extensive areas of glazing which are out of character with the Warrandyte Township.

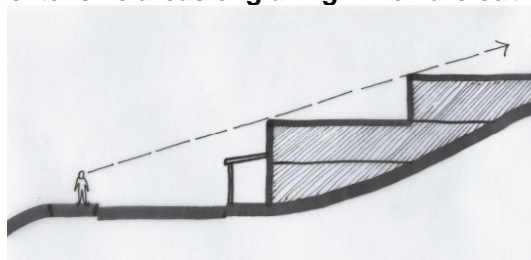

Additions should not dominate the streetscape. Where 3 or more levels are proposed, site lines are restricted to two storeys from the streetscape.



Substantially larger buildings which dominate the streetscape are to be avoided.

Openings

Objective 3.6

To ensure openings visible from the street are consistent with existing openings.

Design suggestions

- The window openings for additions and alterations visible from the street should have similar ratios of glazing to wall as contributory buildings in the street.
- Glazing types and scales should be consistent with the style of the building.
- Bands of windows should be avoided where they do not reflect the patterning of contributory heritage buildings.
- Avoid the use of reflective or tinted glass.

Verandahs

Objective 3.7

To ensure verandahs compliment the character of the streetscape and heritage area.

Design suggestions

- New verandahs should compliment the height and form of existing verandahs.
- New verandahs to non contributory buildings should be contemporary and not replicate the historic verandahs.
- Use of simple skillion roofed verandahs with square timber posts.

Materials

Objective 3.8

To ensure materials and finishes are sympathetic to the streetscape.

Design suggestions

- Materials and finishes should be of muted tones.
- Avoid reflective materials, particularly Zinalume finishes.
- Ensure materials and finishes compliment and integrate with the existing building materials.

Exterior Painting

Objective 3.9

To ensure colour schemes for non contributory buildings relate to the character of the streetscape and heritage area.

Design suggestions

- Colour schemes for non-contributory buildings in residential areas, should be selected so that they do not dominate the streetscape.
- Large areas should be painted in colours appropriate to Warrandyte. The highlighting of fascias, gutters, doors and window frames should expand upon these colours.



A row of shops in Yarra Street containing contributory and non contributory buildings

Design Excellence

Objective 3.10

To ensure additions and alterations strive for excellence and achieve high aesthetic values.

Design suggestions

- Alterations and additions should be designed to achieve high levels of functionality.
- Alterations and additions should be of architectural, aesthetic and visual interest.
- Incorporate the strengths of contemporary design in alterations and additions.

Detailing

Objective 3.11

To ensure that design details including external paint colours, signs and other elements are sympathetic to the streetscape.

Design suggestions

- Standard building designs for Commercial franchise businesses should be modified to respect the significance of the streetscape.
- Designs for additions and alterations should use contemporary details that are sympathetic with the heritage buildings and avoid replication of historic detail from adjacent heritage commercial buildings.
- Parapets can be shaped, but should be done so in a contemporary and simplified manner.
- Corporate signage should meet the heritage signage guidelines. It should be appropriate in placement, scale and colours and should not dominate the streetscape.



The important curve in the road giving special views of the township

Roads, Paths & Views

Objective 3.12

To ensure that retaining walls, pathways and roads are retained and new development contributes to the existing character.

Design suggestions

- Retain the existing road and pathway alignment.
- Maintain and repair when necessary the existing stone retaining walls and steps.
- Retain important view termination points including the bends in the road, landmark buildings and roadside features like stone walls.
- If retaining walls are required they should be constructed of stone and should be similar in appearance to existing retaining walls that are characteristic of the area.



Retaining walls, pathways & fences contribute to the significance of Warrandyte Township

Fences

Objective 3.13

To ensure new and replacement fences are sympathetic to the heritage values of the township.

Design suggestions

- New fences should be consistent with the heights, the relation of solid to opening and materials consistent with other fences in the street.
- Replacement fences may be constructed to the same height as the existing fence, but must not be higher than the existing fence (where the existing height is greater than 1.2 metres).
- New and/or replacement fences located at the front of a property should be visually permeable.
- New fences should not replicate historical detailing. Individual details may be incorporated.
- Simple picket fences, post and rail or post and wire fences are preferred.
- Elaborate fences that are inconsistent with the streetscape are not preferred.
- Solid fences, brick fences and pine log fences are inappropriate.
- No fences should be constructed over 1200mm in height.
- Fence colours should be consistent with the style of the dwelling and be in keeping with the streetscape.
- A permeable fence may be appropriate in combination with hedging or other planting adjacent to the fence where there is a need for privacy.

Appropriate fence types for Warrandyte Township

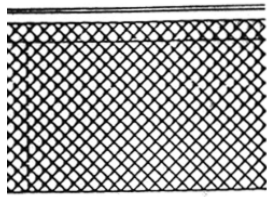

Chain wire with timber rail and plinth

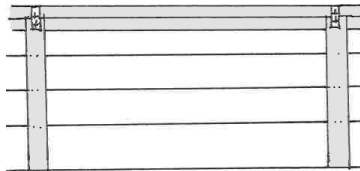

Post and wire

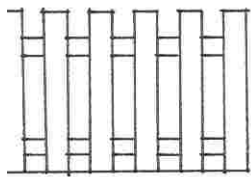

Simple timber pickets

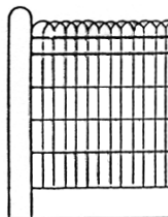

Wire with timber post and plinth



Side & Rear Fences

Objective 3.14

To ensure new or replacement fences, where visible in public views, should be sympathetic to the heritage character of the township.

Design suggestions

- New or replacement fences that will be visible in public views from the rear, side or front of a property should be low in height (no higher than 1.2 metres) and visually permeable.
- Side and rear fences which are visible in public views should generally be constructed in accordance with the requirements for front fences as outlined above.



A good example of a side fence in the commercial area of Warrandyte

The low permeable fence between this public playground and an adjacent commercial building retains views across the landscape.



Pathway and property fencing in the centre of the Township

The above photograph shows that permeable fences to properties and the adjoining pathway in the Township allow landscaping and views between properties to dominate.

Car Parking

Objective 3.15

To ensure that car parking has minimal impact on the streetscape.

Design suggestions

- Location of car parking areas in the front setback of buildings should be avoided.
- New car parking area should be located to the rear of existing buildings.



Commercial properties at the east end of Yarra Street

Car parking provided in front of these shops detracts from the traditional line of commercial property frontages.

Exterior Paint Colour Chart

Colour schemes for non contributory buildings in the commercial area, should be selected so that they do not dominate the streetscape. The following exterior paint colour chart provides some examples of colours that may be considered for external painting schemes.

The primary palette is based on natural features and materials present in Warrandyte and are suitable for large areas such as walls. The secondary palette expands on these colours and provides a degree of flexibility. These colours are suitable for highlighting particular elements of a building such as fascias, gutters, doors and window frames.

Note that these colours are a guide only. Reference numbers from the Pantone (PMS) and Dulux colour systems have been provided for easy reference and might not match each other exactly.

Primary palette

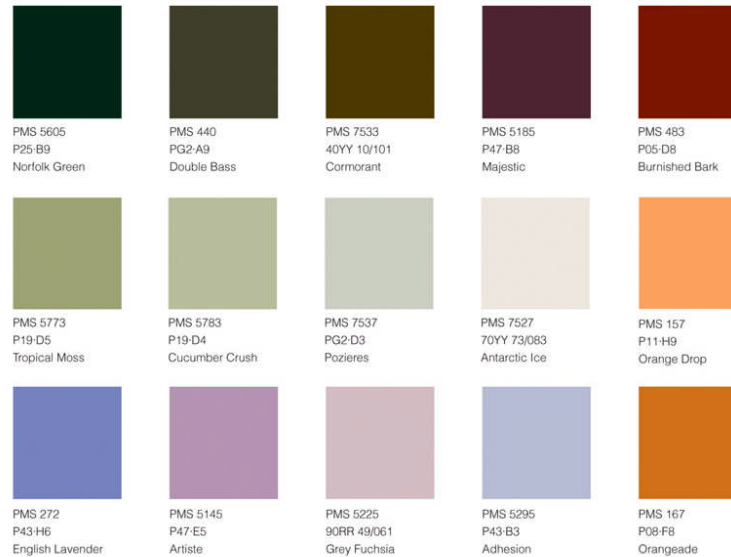

Secondary palette

Table 1 - List of Contributory Places within the Warrandyte Township Heritage Precinct

The following table details each of the heritage places that have been identified as being of 'contributory' significance within the Warrandyte Township Heritage Precinct. All of the listed heritage places are shown on the following map. The Map No. in the table corresponds with the number shown on the map of the Warrandyte Township Heritage Precinct.

Map No.	Street No.	Street Name	Heritage Place	HO No.
1	1/3	Anderson Street	House - (formally 76 Yarra St)	HO191
2	119	Brackenbury Street	House	HO191
3	130	Brackenbury Street	House	HO191
4	139	Brackenbury Street	House	HO191
5	151	Brackenbury Street	House	HO21
6	152	Brackenbury Street	House	HO191
7	32	Mullens Road	House	HO191
8	2	Russell Road	Cottage	HO191
9	5-7	Stiggant Street	St Stephen's Anglican Church	HO157
10	32	Yarra Street	Cottage	HO191
11	36-38	Yarra Street	Former Shop and residence	HO193
12	44	Yarra Street	House	HO191
13	45-55	Yarra Street	Brick veneer building	HO191
14	48	Yarra Street	House	HO191
15	56	Yarra Street	House	HO191
16	64	Yarra Street	House	HO191
17	65	Yarra Street	House	HO191
18	70	Yarra Street	Cottage	HO191
19	71	Yarra Street	House	HO194
20	77	Yarra Street	3 Oak Trees	HO191
21	78	Yarra Street	House	HO191
22	93	Yarra Street	Former Warrandyte Dairy	HO191
23	95	Yarra Street	Cottage	HO191
24	96	Yarra Street	House	HO191
25	98	Yarra Street	House with	HO191
26	103	Yarra Street	Former Gospel Chapel	HO191

Map No.	Street No.	Street Name	Heritage Place	HO No.
27	110-136	Yarra Street	Grand Hotel	HO195
28	111-117	Yarra Street	Former Warrandyte Post Office	HO191
29	141	Yarra Street	The Diary Tree	HO196
30	152-156	Yarra Street	Shop	HO191
31	158	Yarra Street	Former Butcher	HO191
32	180-186	Yarra Street	Mechanics Institute	HO197
33	180-186	Yarra Street (rear)	Former Warrandyte Fire Station	HO198
34	183-187	Yarra Street	Shop	HO191
35	189	Yarra Street	Shop	HO191
36	193-197	Yarra Street	Bakery	HO191
37	204	Yarra Street	House	HO191
38	207	Yarra Street	Shop	HO191
39	212	Yarra Street	House	HO191
40	216-218	Yarra Street	War Memorial	HO191
41	220-230	Yarra Street	House	HO191
42	232-236	Yarra Street	Former Wine Hall	HO199
43	286	Yarra Street	House	HO191
44	300	Yarra Street	Alexa Goyder's House	HO200
45	306	Yarra Street	House	HO191
46	308	Yarra Street	Remains of South Caledonia Mine	HO191
47	314	Yarra Street	House - (formally 161 Brackenbury St)	HO22
48	318	Yarra Street	House	HO23
49	321	Yarra Street	Stonehouse	HO165
50	322	Yarra Street	Cottage	HO191

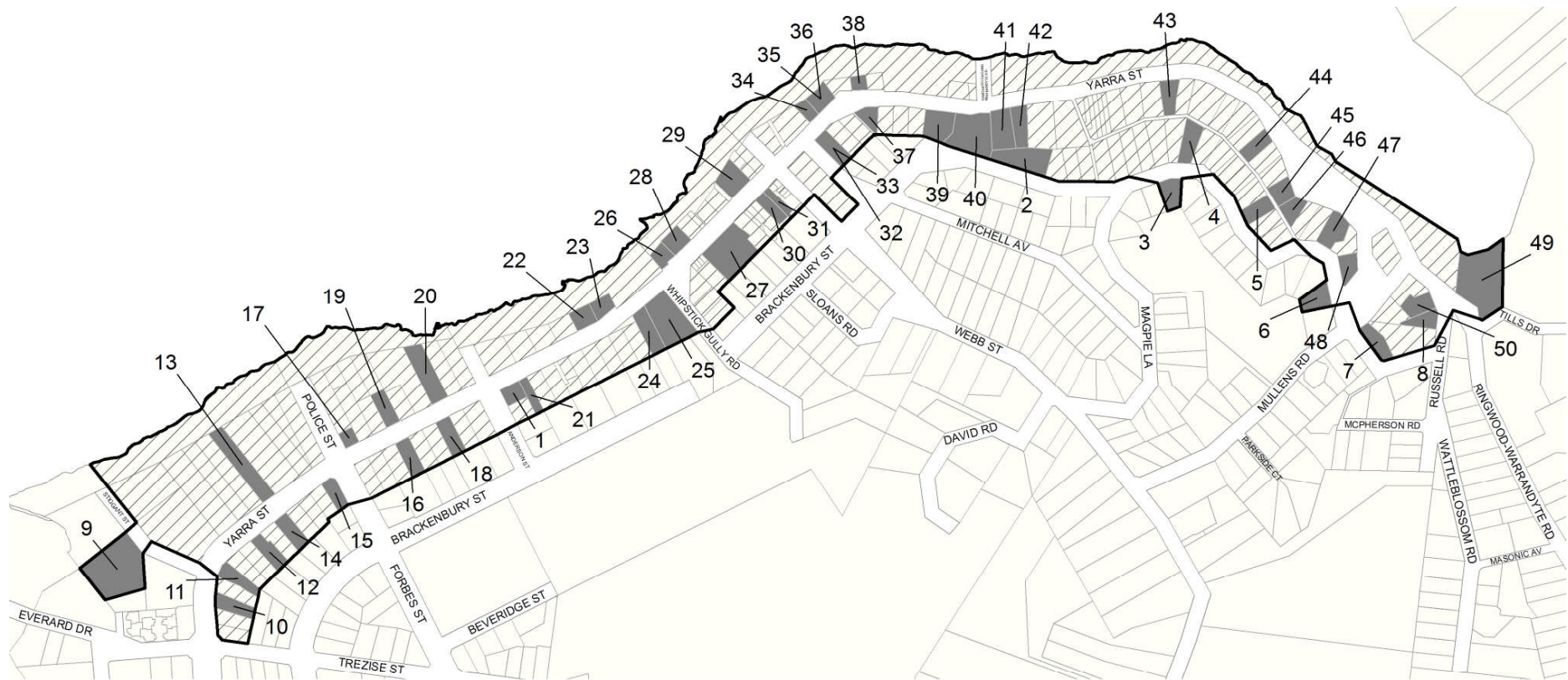

Warrandyte Township Heritage Precinct

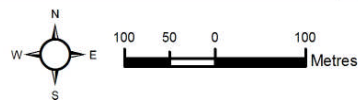

Heritage Contacts and Reference Documents

Information about the requirements of the Manningham Planning Scheme and planning applications relating to the Warrandyte Township Heritage Precinct is available by contacting Council's Statutory Planning Department on 9840 9495 or Council's Heritage Planner on 9840 9129.

Further technical advice is available, and appointments for Council's Heritage Advisory Service can be made by contacting Council's Economic and Environmental Planning Unit on 9840 9362. It is strongly encouraged that applicants talk to the Council's Heritage Advisor at pre-application stage to discuss appropriate options for change.

Other heritage contacts and Council reference documents which may be of assistance are listed below.

Heritage Contacts

Heritage Victoria
Department of Planning & Community
Development
Level 7, 8 Nicholson St,
East Melbourne VIC 3002
Ph: 9637 9475

National Trust of Australia
Tasma Terrace, 4 Parliament Place,
East Melbourne VIC 3002
Ph: 9654 4711

Australian Heritage Council
Department of the Environment &
Heritage
GPO Box 787,
Canberra ACT 2601
Ph: (02) 6274 1111

Warrandyte Historical Society
111 Yarra Street,
Warrandyte VIC 3113
Ph: 9844 4176

Council Reference Documents

- *City of Doncaster and Templestowe Heritage Study*, Context Pty Ltd 1991;
- *City of Doncaster and Templestowe Heritage Study Additional Sites Recommendations*, Richard Peterson 1993;
- *Doncaster & Templestowe Heritage Study Additional Historical Research*, Carlotta Kellaway 1994;
- *Warrandyte Signage Strategy*, David Lancashire Design, 2005;
- *Warrandyte Urban Design Framework*, Urban Initiatives 2005
- *Warrandyte River Reserve Management Plan*, Manningham City Council (2005).
- *Warrandyte Township Precinct Citation & Plan*, Context Pty Ltd, 2006.

Prepared for

Manningham City Council

by

HLCD Pty Ltd

ABN 63 083 840 724 email: hlcd@hlcd.com.au
28 Drummond St Carlton VIC 3053 ph 03 9654 4801 fax 03 9654 4803

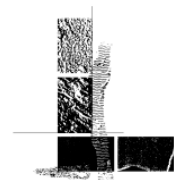

HLCD